

SPANNERS

The key to success: perfect work results can only be reached with the perfect spanner. The name GEDORE stands for exact nominal dimensions, long service life, full torque transmission and work safety worldwide.

The GEDORE story began with the spanner in 1919. Since then, the range of open-end, ring, ring ratchet and special spanners has grown steadily. Classics such as the No. 6 and the 7R ratchet spanner continue to set standards in terms of precision and reliability. All GEDORE spanners are manufactured from high-quality steel in a forging

furnace, have precise nominal dimensions and a complex surface finish. Quality made in Germany for optimum working quality and safety.



PRECISION, CORRECT MEASUREMENTS AND PERFECT FIT

- The most important requirements for a safe working environment
- Easy transmission of available torque
- Long life of nut and bolt
- Profiles easy on the bolt heads (UD, jaw, hexagon)
- Minimum production tolerances ensure that spanners fit perfectly on bolts





WHY MATT CHROME-PLATED?

- Secure grip, even with oily hands
- Double corrosion protection



PRECISE
RELIABLE



DURABLE AND VERY RESILIENT

- For hard continuous use and safety in use
- High bending stiffness - bending instead of breaking or splintering when overloaded
- Extreme hardness for long service life

WIDEST RANGE

- Extremely wide range in standard, non-standard, metric (mm), imperial (AF) and Whitworth (W) dimensions.
- Available individually or in convenient sets or modules

GEDORE UNIT-DRIVE

The GEDORE UNIT-DRIVE profile prevents the "round turning" of screw heads by means of a wave profile without pointed or sharp edges.

TRADITIONAL PROFILE

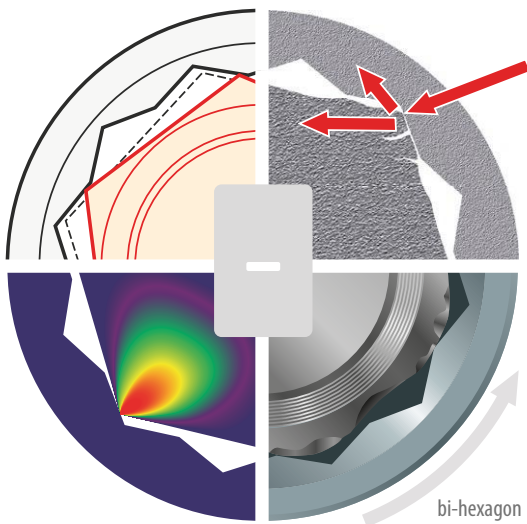

1 The reduced contact surface lessens the force closure. Certain torque transfer is no longer possible and can become a risk.

2 The influence exerted of the sharp edges raises the notching effect on the bolt. The profile is ruined.

3 Since there is no longer any torque transfer, the rounded bolt profiles cannot be unscrewed - the tool keeps on slipping.

4 Pronounced force on the tip of the bolt profile. Concentrated pressure deforms the bolt.

1 A large contact surface provides a secure force closure even for those bolts whose sizes lie outside of the tolerances.

2 Uniform distribution of the force on the bolt flanks. The resulting reduced notching effect stops the bolt from turning round and round.

3 Gentle torque transfer enables even worn bolts to be unscrewed with every certainty - no slipping of the tool at all.

4 Thanks to the optimally distributed force up to 20 % higher torques can be transferred.

GEDORE UNIT-DRIVE PROFILE (UD-PROFILE)

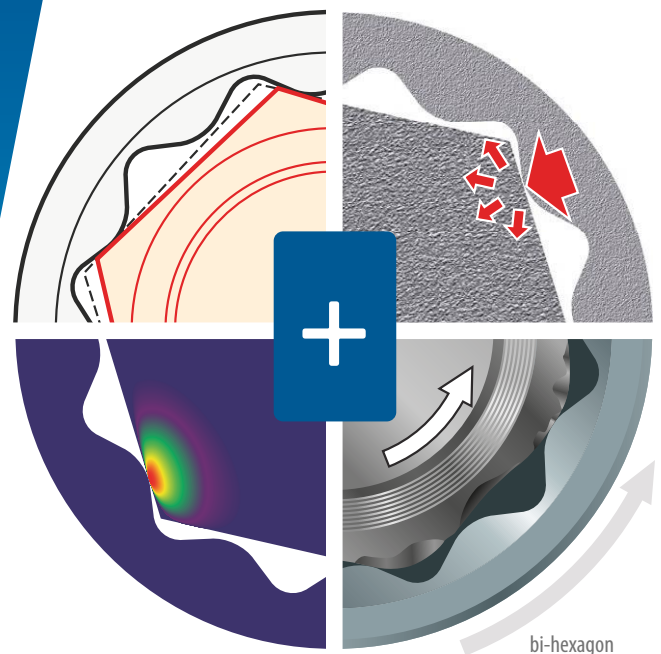

OPTIMUM FRICTIONAL LOCKING PROTECTS SCREW HEADS



Enlarged, round contact surfaces of GEDORE tools ensure reliable torque transmission, which acts evenly on the screw head.

The notch effect, reduced to a minimum as a result, prevents damage to the screw head profile - a plus for safety, as slipping and spinning is prevented, even with damaged screw heads.

i SPANNER RATCHET

The revolution

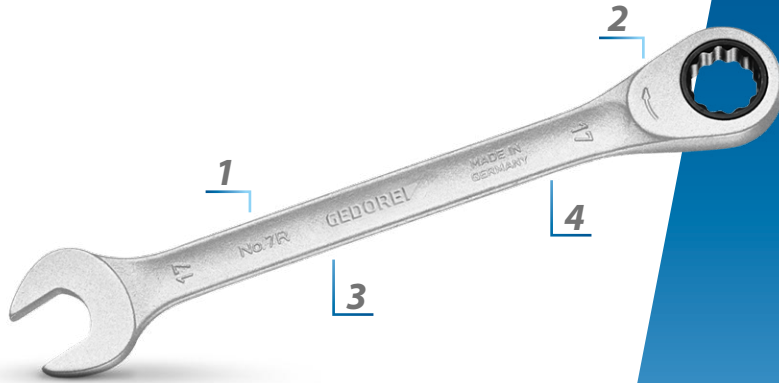

- 1** HOLLOW PROFILE
COMFORTABLE TO HOLD
- 2** FOR RATCHET LOOSENING
AND FAST TIGHTENING
- 3** WARP-RESISTANT GEOMETRY
WITH DOUBLE T-GIRDER EFFECT
- 4** NON-GLARE LOOK THANKS TO
MATT CHROME-PLATING

- With same size each end
- UD profile
- High torque transfer
- GEDORE vanadium steel 31CrV3
- Non-glare look thanks to matt chrome plating, locking insert and pawl manganese-phosphated

- Hot forged
- Jaw: ground precisely to exact nominal size for optimum contact areas
- In combination with adaptor no. 7 RA or 7 RB (please order separately) the spanner no. 7 R and 7 UR can be used as a (bit) ratchet

7 R

Combination ratchet spanner
Flat pattern

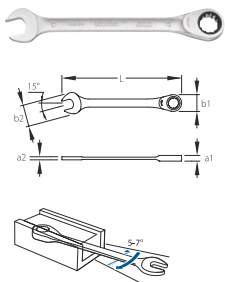

- With same size each end
- For ratcheting release or quick tightening
- Flat pattern
- High torque transfer

Code	No.	Ø mm	L	kg
2297051	7 R 8	8,0	140	0,032
2297078	7 R 9	9,0	150	0,042
2297086	7 R 10	10	160	0,054
2297094	7 R 11	11	164	0,063
2297108	7 R 12	12,0	170	0,069
2297116	7 R 13	13,0	180	0,088
2297124	7 R 14	14,0	190	0,101
2297132	7 R 15	15,0	200	0,125
2297140	7 R 16	16,0	212	0,137
2297159	7 R 17	17,0	225	0,160

Code	No.	Ø mm	L	kg
2297167	7 R 18	18,0	237	0,197
2297175	7 R 19	19,0	250	0,202
2219433	7 R 21	21,0	274	0,262
2297191	7 R 22	22,0	292	0,319
2297205	7 R 24	24,0	325	0,520
2297213	7 R 27	27,0	359	0,590
2297221	7 R 30	30,0	399	0,780
2297248	7 R 32	32,0	424	0,920
2219549	7 R 34	34,0	449	1,011
2219557	7 R 36	36,0	480	1,208

7 UR

Combination ratchet spanner,
reversible

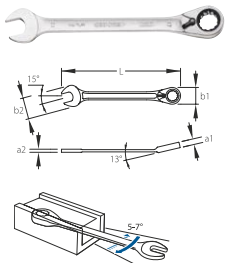

- With same size each end
- For ratchet loosening and fast tightening
- Ring 13° offset from shaft, reversible
- High torque transfer

Code	No.	Ø mm	L	kg
2297256	7 UR 8	8,0	140	0,037
2297264	7 UR 9	9,0	150	0,043
2297272	7 UR 10	10,0	160	0,053
2297280	7 UR 11	11,0	164	0,062
2297299	7 UR 12	12,0	170	0,069
2297302	7 UR 13	13,0	180	0,081
2297310	7 UR 14	14,0	190	0,098
2297329	7 UR 15	15,0	200	0,120

Code	No.	Ø mm	L	kg
2297337	7 UR 16	16,0	212	0,153
2297345	7 UR 17	17,0	225	0,166
2297353	7 UR 18	18,0	237	0,178
2297361	7 UR 19	19,0	250	0,218
2244500	7 UR 21	21,0	274	0,264
2297388	7 UR 22	22,0	292	0,319
2297396	7 UR 24	24,0	325	0,449

7 R-005

Combination ratchet spanner set
5 pieces



- Practical composition
- For ratchet loosening and fast tightening
- Flat pattern
- In plastic case

Code	No.	Contents	Pieces	kg
2297434	7 R-005	7 R 8 10 13 17 19 mm	5	0,932

Spanners

7 R-012

Combination ratchet spanner set
12 pieces

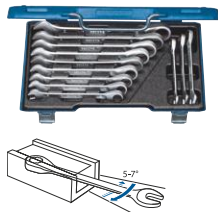

- > Practical composition
- > For ratchet loosening and fast tightening
- > Flat pattern
- > In robust sheet metal case

Code	No.	Contents	Pieces	
2297442	7 R-012	7 R 8 10 12 13 14 15 16 17 18 19 mm	12	2,84

7 UR-005

Combination ratchet spanner set, reversible
5 pieces



- > Practical composition
- > For ratchet loosening and fast tightening
- > Ring 13° offset from shaft, reversible
- > In plastic case

Code	No.	Contents	Pieces	
2327651	7 UR-005	7 UR 8 10 13 17 19 mm	5	0,93

7 UR-012

Combination ratchet spanner set, reversible
12 pieces



- > Practical composition
- > For ratchet loosening and fast tightening
- > Ring 13° offset from shaft, reversible
- > In robust sheet metal case

Code	No.	Contents	Pieces	
2297418	7 UR-012	7 UR 8 9 10 11 12 13 14 15 16 17 18 19 mm	12	2,84

7 RA 183

Ratchet spanner set with pliers spanner



- > Flexible in limited space
- > Flat pattern
- > Practical composition
- > With UD profile
- > With drive adapter for 1/4" and 1/2" inserts
- > Incl. pliers wrench size 7 (for 0 - 42mm / 0" - 1 5/8")
- > With attachable protective jaws for sensitive surfaces

Code	No.	Contents	Pieces	
3416356	7 RA 183	7 R Open-end spanner with ring ratchet 8 10 13 17 19 mm 7 RA-12,5 Adapter 1/2" 19 mm 7 RA-6,3 Adapter 1/4" 10 mm 183 7 TC Pliers spanner incl. jaws WK 19DM/IN19 L Box empty EI-7 RA 183 Foam insert empty	10	1,7

7 RA

Adaptor for 7 R/7 UR



- > The adaptor transforms the ring ratchet spanner into a ratchet
- > With push-button release, wear-resistant and manganese phosphated
- > Fast-turning ring for swift release or tightening
- > Secure adaptor fit in the ring ratchet thanks to circlip

Code	No.				H	
2320495	7 RA-6,3	10	1/4"	6,3	18	0,011
2320487	7 RA-10	13	3/8"	10,0	24	0,030
2320479	7 RA-12,5	19	1/2"	12,5	32	0,070

7 RB

Bit adaptor
for 7 R/7 UR



- > The adaptor transforms the ring ratchet spanner into a bit ratchet
- > Secure adaptor fit in the ring ratchet thanks retaining ball
- > With magnetic holder

Code	No.	mm	"	mm	H	kg
2329239	7 RB-6,3	10	1/4"	6,3	20,5	0,011
2327643	7 RB-8	10	5/16"	8,0	23	0,015

i NO. 1 B

The strong all-rounder



- 1** JAW: GROUND PRECISELY TO EXACT NOMINAL SIZE FOR OPTIMUM CONTACT AREAS
- 2** NON-GLARE LOOK THANKS TO MATT CHROME-PLATING
- 3** RING: 10° OFFSET FROM SHAFT, WITH UD PROFILE FOR GENTLE TRANSMISSION OF FORCE
- 4** SLIM RIBBED OPEN END FOR ADDED STRENGTH GUARANTEES MAXIMUM TORQUES

- Acc. to DIN 3113 Form B, ISO 3318, ISO 7738
- Sizes 5 and 5.5 mm with hexagon ring, up from size 6 mm with UD profile
- GEDORE vanadium steel 31CrV3, chrome plated
- Carefully forged and professionally machined

- Ring: cranked and angled 10°, with UD Profi for gentle power transmission
- Overloading indicated by deformation
- The offset ring ensures a better grip on deep seated or inset nuts or bolts
- Top-grade industrial quality for the hardest of continuous use

1 B (MM)

Combination spanner
with same size each end
metric

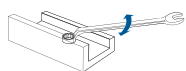
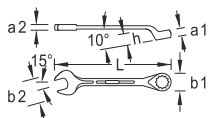

- > Size 5 and 5.5 mm with hexagonal ring, from 6 mm with UD profile for gentle power transmission
- > Ring cranked and angled 10°
- > For actuating recessed or deep-set nuts or screws

* not standardised

Code	No.	mm	L	kg	Code	No.	mm	L	kg
6000240	1 B 5	5	100	0,015	6002450*	1 B 25	25	328	0,431
6000320	1 B 5,5	5.5	100	0,015	6002530*	1 B 26	26	340	0,481
6000400	1 B 6	6	100	0,016	6002610	1 B 27	27	352	0,514
6000590	1 B 7	7	112	0,028	6002880*	1 B 28	28	370	0,578
6000670	1 B 8	8	125	0,026	6002960*	1 B 29	29	370	0,546
6000750	1 B 9	9	138	0,035	6003180	1 B 30	30	390	0,672
6000830	1 B 10	10	148	0,042	6003260	1 B 32	32	412	0,684
6000910	1 B 11	11	158	0,050	6003340*	1 B 33	33	412	0,827
6001050	1 B 12	12	168	0,064	6004150	1 B 34	34	412	0,784
6001130	1 B 13	13	185	0,080	6003420	1 B 36	36	460	1,147
6001210	1 B 14	14	198	0,091	6003500*	1 B 38	38	460	1,081
6001480	1 B 15	15	210	0,139	6003690	1 B 41	41	520	1,452
6001560	1 B 16	16	220	0,128	6003770	1 B 46	46	550	1,893
6001640	1 B 17	17	232	0,153	6003850	1 B 50	50	580	2,268
6001720	1 B 18	18	245	0,183	6003930	1 B 55	55	620	2,900
6001800	1 B 19	19	258	0,210	6004070	1 B 60	60	660	3,600
6001990*	1 B 20	20	270	0,245	6004660*	1 B 65	65	710	4,415
6002020	1 B 21	21	280	0,281	6004740*	1 B 70	70	760	5,625
6002100	1 B 22	22	292	0,294	6004820*	1 B 75	75	810	6,545
6002290*	1 B 23	23	305	0,350	6004900*	1 B 80	80	860	8,790
6002370	1 B 24	24	318	0,372					

Spanners

1 B (AF)

Combination spanner with same size each end inch

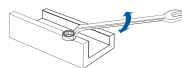
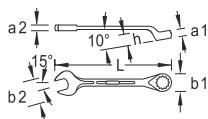

- > With UD profile for gentle power transmission, from SW 1.3/8" 12-edge ring
- > Ring cranked and angled 10°
- > For actuating recessed or deep-set nuts or screws

Code	No.	AF	L	kg	Code	No.	AF	L	kg
6005120	1 B 1/4AF	1/4"	100	0,016	6006870	1 B 1.1/4AF	1.1/4"	412	0,861
6005200	1 B 5/16AF	5/16"	125	0,027	6006950	1 B 1.5/16AF	1.5/16"	412	0,789
6005390	1 B 3/8AF	3/8"	148	0,045	6007090	1 B 1.3/8AF	1.3/8"	460	1,099
6005470	1 B 7/16AF	7/16"	158	0,053	6007170	1 B 1.7/16AF	1.7/16"	460	1,085
6005550	1 B 1/2AF	1/2"	185	0,085	6007250	1 B 1.1/2AF	1.1/2"	460	1,113
6005630	1 B 9/16AF	9/16"	198	0,099	6007330	1 B 1.5/8AF	1.5/8"	520	1,457
6005710	1 B 5/8AF	5/8"	220	0,136	6007410	1 B 1.3/4AF	1.3/4"	550	1,896
6005980	1 B 11/16AF	11/16"	245	0,192	6007680	1 B 1.13/16AF	1.13/16"	550	1,870
6006010	1 B 3/4AF	3/4"	258	0,209	6007760	1 B 1.7/8AF	1.7/8"	550	1,821
6006280	1 B 13/16AF	13/16"	280	0,269	6007840	1 B 2AF	2"	580	2,280
6006360	1 B 7/8AF	7/8"	292	0,308	6007920	1 B 2.1/16AF	2.1/16"	580	2,250
6006440	1 B 15/16AF	15/16"	318	0,403	6008060	1 B 2.3/16AF	2.3/16"	620	2,855
6006520	1 B 1AF	1"	340	0,473	6008140	1 B 2.1/4AF	2.1/4"	620	2,820
6006600	1 B 1.1/16AF	1.1/16"	352	0,559	6008220	1 B 2.3/8AF	2.3/8"	660	3,510
6006790	1 B 1.1/8AF	1.1/8"	370	0,587	6008300	1 B 2.7/16AF	2.7/16"	660	3,630

1 B (WW)

Combination spanner with same size each end Whitworth

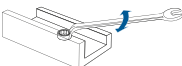
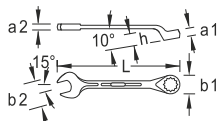

- > With 12-sided ring
- > Ring cranked and angled 10°
- > For actuating recessed or deep-set nuts or screws

Code	No.	Whitw.	L	kg	Code	No.	Whitw.	L	kg
6009540	1 B 1/8W	1/8W	138	0,035	6010390	1 B 5/8W	5/8W	370	0,573
6009620	1 B 3/16W	3/16W	158	0,053	6010470	1 B 11/16W	11/16W	390	0,713
6009700	1 B 1/4W	1/4W	185	0,082	6010550	1 B 3/4W	3/4W	412	0,803
6009890	1 B 5/16W	5/16W	210	0,115					
6009970	1 B 3/8W	3/8W	245	0,190					
6010040	1 B 7/16W	7/16W	280	0,274					
6010200	1 B 9/16W	9/16W	340	0,477					

1 B (MM) / 1 B (AF)

Combination spanner set metric

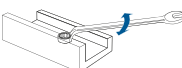
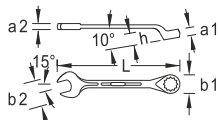

- > With UD profile for gentle power transmission, from SW 1.3/8" 12-edge ring
- > Ring cranked and angled 10°
- > For actuating recessed or deep-set nuts or screws

Code	No.	Contents	Pieces	kg
6011870	1 B-08	10 12 13 14 17 19 22 24 mm	8	2,600
6011950	1 B-080	8 9 10 11 13 14 17 19 mm	8	1,000
6013300	1 B-08A	3/8 7/16 1/2 9/16 5/8 3/4 7/8 1"	8	1,410
6012250	1 B-011	8 9 10 11 12 13 14 15 17 19 22 mm	11	1,190
6012170	1 B-012	10 11 12 13 14 17 19 22 24 27 30 32 mm	12	3,390
6012840	1 B-0112	6 7 8 9 10 11 12 13 14 15 17 19 mm	12	0,925
6013650	1 B-014A	5/16 3/8 7/16 1/2 9/16 5/8 11/16 3/4 13/16 7/8 1.1/16 1.1/8 1.1/4"	14	3,488
6000160	1 B-0115	6 7 8 9 10 11 12 13 17 19 22 24 27 30 32 mm	15	3,385
6012680	1 B-017	6 7 8 9 10 11 12 13 14 15 16 17 18 19 20 21 22 mm	17	2,300
6013060	1 B-020	8 9 10 11 12 13 14 15 16 17 18 19 21 22 23 24 26 27 30 32 mm	20	5,500
6012920	1 B-026	6 7 8 9 10 11 12 13 14 15 16 17 18 19 20 21 22 23 24 25 26 27 28 29 30 32 mm	26	7,500

i NO. 7

The handy

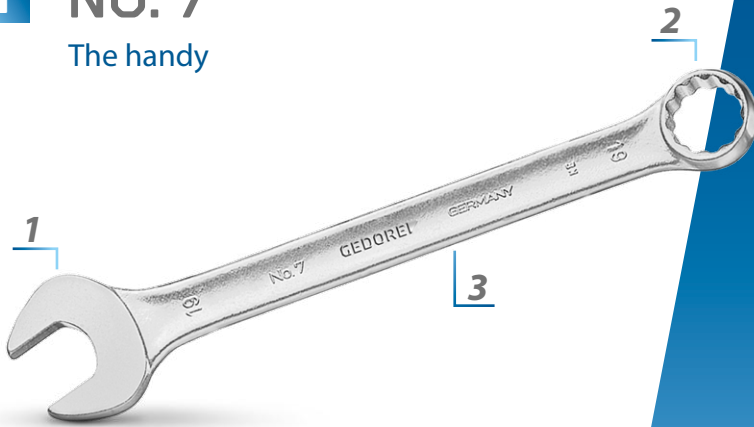

1 JAW: GROUND PRECISELY TO EXACT NOMINAL SIZE FOR OPTIMUM CONTACT AREAS

2 RING: 15° OFFSET FROM SHAFT, WITH UD PROFILE FOR GENTLE TRANSMISSION OF FORCE

3 NON-GLARE LOOK THANKS TO MATT CHROME-PLATING

- Acc. to DIN 3113 Form A, ISO 3318, ISO 7738
- GEDORE vanadium steel 31CrV3, chrome plated
- Carefully forged and professionally machined
- Slim jaw and jaw walls make this spanner lighter overall
- Overloading indicated by deformation

- Secure grip thanks to hollow shaft - very ergonomic and handy
- Non-glare look thanks to matt chrome-plating
- Designed for universal use
- Top-grade industrial quality for the hardest of continuous use

7 (MM)

Combination spanner with same size each end metric

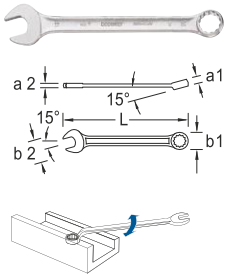

- > Slim jaw and jaw walls make this spanner lighter overall
- > Ring 15° angled, with UD profile - for gentle power transmission
- > Mouth position 15°, precisely ground to exact nominal dimension for optimum contact surfaces

* not standardised

Code	No.	Ø mm	L	kg	Code	No.	Ø mm	L	kg
6080680*	7 3	3	78	0,006	6090720	7 17	17	210	0,111
6080760*	7 3,2	3.2	78	0,006	6091880	7 18	18	220	0,121
6080840*	7 3,5	3.5	78	0,006	6090800	7 19	19	230	0,140
6080920*	7 4	4	85	0,010	6091960*	7 20	20	240	0,170
6081060*	7 4,5	4.5	85	0,009	6092180	7 21	21	252	0,182
6081140*	7 5	5	92	0,011	6090990	7 22	22	262	0,200
6081220*	7 5,5	5.5	92	0,011	6092260*	7 23	23	270	0,223
6089550	7 6	6	100	0,014	6091020	7 24	24	282	0,264
6089630	7 7	7	110	0,017	6092340*	7 25	25	290	0,295
6089710	7 8	8	120	0,024	6092420*	7 26	26	302	0,309
6089980	7 9	9	130	0,028	6091100	7 27	27	310	0,344
6090050	7 10	10	140	0,033	6092500*	7 28	28	320	0,375
6090130	7 11	11	150	0,042	6092690*	7 29	29	330	0,394
6090210	7 12	12	160	0,050	6091290	7 30	30	340	0,428
6090480	7 13	13	170	0,058	6091370	7 32	32	370	0,535
6090560	7 14	14	180	0,069	1827987	7 34	34	420	0,624
6090640	7 15	15	190	0,080	6089470	7 36	36	460	0,726
6091610	7 16	16	200	0,092					

WWW.GEDORE.COM

Spanners

7 (AF)

Combination spanner with same size each end inch

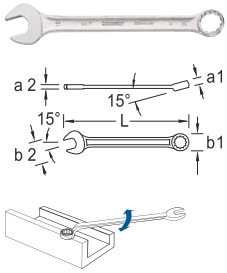

- > Slim jaw and jaw walls make this spanner lighter overall
- > Ring 15° angled, with UD profile - for gentle power transmission
- > Mouth position 15°, precisely ground to exact nominal dimension for optimum contact surfaces

Code	No.	AF	L	kg	Code	No.	AF	L	kg
1436767	7 3/16AF	3/16"	85	0,010	6099510	7 9/16AF	9/16"	180	0,063
1436775	7 7/32AF	7/32"	92	0,011	6099780	7 5/8AF	5/8"	200	0,104
6098700	7 1/4AF	1/4"	100	0,013	6099860	7 11/16AF	11/16"	220	0,122
6098890	7 5/16AF	5/16"	120	0,024	6099940	7 3/4AF	3/4"	230	0,148
6098970	7 11/32AF	11/32"	130	0,026	6100030	7 13/16AF	13/16"	252	0,187
6099190	7 3/8AF	3/8"	140	0,038	6100110	7 7/8AF	7/8"	262	0,192
6099270	7 7/16AF	7/16"	150	0,041	6100380	7 15/16AF	15/16"	282	0,296
6099430	7 1/2AF	1/2"	170	0,056	6100460	7 1AF	1"	302	0,287

7 XL

Combination spanner extra long

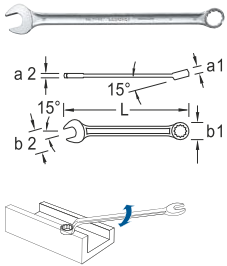

- > With same size each end
- > Extra long shaft for deep range of use and more torque
- > Slim jaw and jaw walls make this spanner lighter overall
- > Ring 15° angled, with UD profile - for gentle power transmission
- > Mouth position 15°, precisely ground to exact nominal dimension for optimum contact surfaces

Code	No.	mm	L	kg	Code	No.	mm	L	kg
1394916	7 XL 7	7	160	0,031	6101000	7 XL 19	19	310	0,276
6080090	7 XL 8	8	170	0,042	6080410	7 XL 21	21	340	0,352
6080170	7 XL 9	9	180	0,054	6101190	7 XL 22	22	350	0,392
6097300	7 XL 10	10	190	0,060	6101270	7 XL 24	24	400	0,521
6097490	7 XL 11	11	200	0,076	6101350	7 XL 27	27	450	0,711
6100540	7 XL 12	12	210	0,086	6101780	7 XL 30	30	480	0,839
6100620	7 XL 13	13	225	0,102	6101430	7 XL 32	32	500	0,956
6100700	7 XL 14	14	235	0,120	6101940	7 XL 34	34	520	1,088
6100890	7 XL 15	15	250	0,147	6101510	7 XL 36	36	550	1,248
6080250	7 XL 16	16	265	0,171	6102080	7 XL 41	41	600	2,000
6100970	7 XL 17	17	280	0,196	6102160	7 XL 46	46	640	2,278
6080330	7 XL 18	18	295	0,233					

7 XL

Combination spanner set extra long



- > With same size each end
- > Extra long shaft for deep range of use and more torque
- > Slim jaw and jaw walls make this spanner lighter overall
- > Ring 15° angled, with UD profile - for easy power transmission
- > Mouth position 15°, precisely ground to exact nominal dimension for optimum contact surfaces

Code	No.	Contents	Pieces	kg
6104880	7 XL-080	8 9 10 11 13 14 17 19 mm	8	0,962
6104960	7 XL-0111	8 10 11 12 13 14 16 17 18 19 22 mm	11	1,794
6095950	7 XL-012	10 11 12 13 14 17 19 22 24 27 30 32 mm	12	4,410

7 (MM) / 7 (AF)

Combination
spanner set
metric

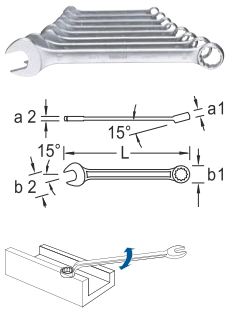

- > Practical composition
- > With same size each end
- > Ring 15° angled, with UD profile - for gentle power transmission
- > Mouth position 15°, precisely ground to exact nominal dimension for optimum contact surfaces

Code	No.	Contents	Pieces	
6092770	7-08	10 12 13 14 17 19 22 24 mm	8	0,973
6092850	7-080	8 9 10 11 13 14 17 19 mm	8	0,536
6091450	7-08A	3/8 7/16 1/2 9/16 5/8 3/4 7/8 1"	8	1,047
6093070	7-011	8 9 10 11 12 13 14 15 17 19 22 mm	11	0,868
6091530	7-0112	6 7 8 9 10 11 12 13 14 15 17 19 mm	12	0,686
6093150	7-012	10 11 12 13 14 17 19 22 24 27 30 32 mm	12	2,700
6093580	7-017	6 7 8 9 10 11 12 13 14 15 16 17 18 19 20 21 22 mm	17	1,465
6093660	7-020	8 9 10 11 12 13 14 15 16 17 18 19 21 22 23 24 26 27 30 32 mm	20	3,360
6093740	7-026	6 7 8 9 10 11 12 13 14 15 16 17 18 19 20 21 22 23 24 25 26 27 28 29 30 32 mm	26	4,665

i NO. 4 R

The double with ratchet





- Flat pattern
- Thin walled rings
- UD profile
- Working angle: 7° up to 14x15 mm, 6° from 16x17 mm to 18x19 mm
- For ratchet loosening and fast tightening
- GEDORE vanadium steel 31CrV3
- Non-glare look thanks to matt chrome plating, locking insert and pawl manganese phosphated
- Hot forged
- Tried-and-tested GEDORE technology combined anew: stable hollow shaft of no. 7 and refined mechanism of the U-20 ratchets
- In combination with adaptor no. 7 RA or 7 RB (please order separately) the spanner no. 4 R can be used as a (bit) ratchet

4 R (MM)

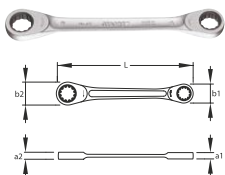
Double ring ratchet
spanner



- > With different key widths
- > Flat pattern
- > Thin walled rings
- > For ratchet loosening and fast tightening
- > With adaptor No. 7 RA or 7 RB (please order separately) the No. 4 R becomes a (bit) ratchet
- > Return angle 7° to 14x15 mm, 6° 16x17 mm to 18x19 mm

Code	No.	 mm	L	
2306719	4 R 8X9	8 x 9	134	0,04
2306743	4 R 10X11	10 x 11	153,5	0,07
2306751	4 R 10X13	10 x 13	165,5	0,08
2306786	4 R 12X13	12 x 13	174,5	0,09
2306794	4 R 14X15	14 x 15	197	0,14
2306816	4 R 17X19	17 x 19	235	0,22
2306832	4 R 18X19	18 x 19	248	0,23

2

Double ended ring
spanner

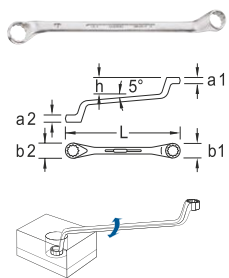

- > With different key widths
- > Rings deeply cranked and angled at 5°
- > For extremely deep or inset bolts

* not standardised

Code	No.	mm	L	kg	Code	No.	mm	L	kg
6010630*	2 5,5X7	5.5x7	170	0,062	6018100	2 22X24	22x24	307	0,412
6015350	2 6X7	6x7	170	0,045	6018370*	2 24X26	24x26	325	0,503
6015430	2 7X8	7x8	180	0,068	6018450	2 24X27	24x27	325	0,506
6015510	2 8X9	8x9	182	0,065	6018530	2 24X30	24x30	345	0,579
6015780	2 8X10	8x10	182	0,072	6018610*	2 25X28	25x28	345	0,565
6015860*	2 9X11	9x11	195	0,086	6018880*	2 27X29	27x29	345	0,678
6015940	2 10X11	10x11	195	0,089	6018960	2 27X30	27x30	345	0,628
6016080*	2 10X12	10x12	195	0,089	6019180	2 27X32	27x32	370	0,701
6016160	2 10X13	10x13	212	0,122	6019260	2 30X32	30x32	370	0,731
6016320	2 11X13	11x13	212	0,129	6019340	2 30X36	30x36	400	0,872
6016590	2 12X13	12x13	212	0,125	6019420	2 32X36	32x36	400	0,878
6016670	2 12X14	12x14	212	0,134	6019500	2 36X41	36x41	440	1,166
6016750	2 13X14	13x14	225	0,156	6019690*	2 38X42	38x42	440	1,207
6016830	2 13X15	13x15	225	0,160	6019770	2 41X46	41x46	485	1,535
6016910	2 14X15	14x15	225	0,154	6019850	2 46X50	46x50	535	2,035
6017050	2 13X17	13x17	245	0,212	6019930*	2 55X60	55x60	610	3,125
6017130	2 14X17	14x17	245	0,227	6025660	2 16X18	16x18	265	0,250
6017210	2 16X17	16x17	245	0,205	6025740	2 18X21	18x21	285	0,327
6017480	2 17X19	17x19	265	0,250	6025820	2 21X24	21x24	307	0,386
6017560	2 18X19	18x19	265	0,258	6025900	2 30X34	30x34	375	0,763
6017720	2 19X22	19x22	287	0,352	6026040	2 34X36	34x36	420	0,929
6017800*	2 20X22	20x22	287	0,345					
6017990	2 19X24	19x24	305	0,419					
6018020*	2 21X23	21x23	305	0,411					

i NO. 2

Offset



- Rings deep offset, strong but thin walls
- Acc. to DIN 838, ISO 3318, ISO 1085, ISO 10104
- GEDORE vanadium steel 31CrV3, chrome plated * not standardised
- Carefully forged and professionally machined:
- Ring: thin-walled, 5° deep offset from shaft, with UD profile for gentle transmission of force
- High bending strength - does not fracture or splinter when overloaded, thus minimising the risk of injury
- Overloading indicated by deformation
- Non-glare look thanks to matt chrome-plating
- Specialist for extremely deep or inset bolts
- Top-grade industrial quality for the hardest of continuous use

2

Double ended ring
spanner set

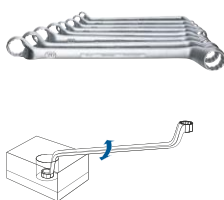

- > Practical composition
- > With different key widths
- > Rings deeply cranked and angled at 5°

Code	No.	Contents	Pieces	kg
6030580	2-8	6x7 8x9 10x11 12x13 14x15 16x17 18x19 20x22 mm	8	1,297
6030740	2-10	6x7 8x9 10x11 12x13 14x15 16x17 18x19 20x22 21x23 24x27 mm	10	2,225
6031120	2-100	6x7 8x9 10x11 12x13 14x15 16x17 18x19 20x22 24x27 30x32 mm	10	2,555
6030900	2-12	6x7 8x9 10x11 12x13 14x15 16x17 18x19 20x22 21x23 24x26 25x28 27x32 mm	12	4,060
6031040	2-120	6x7 8x9 10x11 12x13 14x15 16x17 18x19 20x22 21x23 24x27 25x28 30x32 mm	12	4,000
6031390	2-122 ISO	6x7 8x9 10x11 12x13 14x15 16x18 17x19 20x22 21x23 24x26 27x32 30x34 mm	12	3,730

4

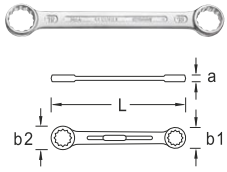
Double ended ring
spanner
straight

- > With different key widths
- > Flat pattern
- > Thin walled rings

* not standardised

Code	No.	mm	L	kg
6052710	4 6X7	6x7	99	0,014
6053010	4 8X9	8x9	114	0,024
6053280	4 8X10	8x10	115	0,022
6053440	4 10X11	10x11	131	0,034
6053520	4 10X13	10x13	149	0,045
6053870	4 12X13	12x13	149	0,049
6054170	4 13X15	13x15	161	0,064
6054330	4 13X17	13x17	167	0,074
6054250	4 14X15	14x15	161	0,064
6054410	4 14X17	14x17	169	0,077
6054680	4 16X17	16x17	169	0,084
6054760	4 17X19	17x19	186	0,098
6054840	4 18X19	18x19	186	0,106
6054920	4 19X22	19x22	209	0,136
6055140*	4 19X24	19x24	233	0,176
6055060*	4 20X22	20x22	209	0,134
6055220*	4 21X23	21x23	233	0,171
6055300	4 22X24	22x24	233	0,184
6055490*	4 24X26	24x26	261	0,230
6055570	4 24X27	24x27	260	0,249
6055650	4 24X30	24x30	290	0,303
6055730*	4 25X28	25x28	289	0,273
6055810	4 27X32	27x32	320	0,373
6056030	4 30X32	30x32	320	0,399
6056110	4 30X36	30x36	357	0,469
6056380	4 32X36	32x36	357	0,492
6056460	4 36X41	36x41	391	0,616
6056540	4 41X46	41x46	431	0,789
6056620	4 46X50	46x50	473	1,035

4

Double ended ring
spanner set

- > Practical composition
- > With different key widths
- > Flat pattern
- > Thin walled rings

Code	No.	Contents	Pieces	kg
6061700	4-8	6x7 8x9 10x11 12x13 14x15 16x17 18x19 20x22 mm	8	0,521
6062000	4-12	6x7 8x9 10x11 12x13 14x15 16x17 18x19 20x22 21x23 24x26 25x28 27x32 mm	12	1,549
6062190	4-120	6x7 8x9 10x11 12x13 14x15 16x17 18x19 20x22 21x23 24x27 25x28 30x32 mm	12	2,000

TX 4

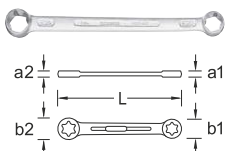
Double ended ring
spanner
straight, for external TX

- > With different key widths

Code	No.	mm	L	kg
6059800	TX 4 E6XE8	5,74 x 7,52 mm	110	0,014
6059990	TX 4 E10XE12	9,42 x 11,17 mm	140	0,039
6060140	TX 4 E14XE18	12,90 x 16,70 mm	180	0,074
6060220	TX 4 E20XE24	18,45 x 22,16 mm	226	0,163

i SPECIAL



- Thin walled rings
- GEDORE vanadium steel 31CrV3, chrome plated
- Specialists in tight spaces

304 (MM)

Half-moon ring spanner

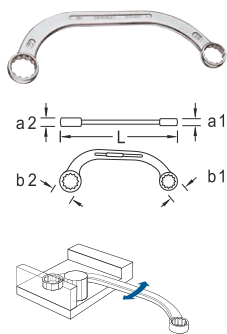

- > Thin walled rings
- > For working in extremely difficult to access areas

Code	No.	mm	L	kg
6470040	304 11X13	11x13	150	0,077
6470120	304 13X17	13x17	185	0,140
6470200	304 14X16	14x16	185	0,137
6470390	304 14X17	14x17	185	0,144
6470470	304 15X17	15x17	185	0,150
6470550	304 19X22	19x22	230	0,261
6470630	304 13X15	13x15	185	0,129
6567550	304 16X18	16x18	185	0,163

400 (MM)

Double ended ring spanner open

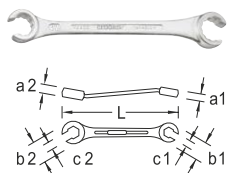

- > With different key widths
- > Application on hydraulic/brake lines
- > Sizes 8x10 to 12x14 mm with hexagon
- > Heads 15° angled
- > Hexagonal opening 30° offset, UD profile opening 15° offset

* not standardised

Code	No.	mm	L	kg
6057190	400 8X10	8x10	140	0,045
6056970*	400 9X11	9x11	145	0,059
6057270	400 10X11	10x11	150	0,064
6051070*	400 10X12	10x12	150	0,073
6057350	400 11X13	11x13	160	0,077
6057430	400 12X14	12x14	170	0,106
6057000*	400 13X15	13x15	180	0,116
6057510	400 14X17	14x17	195	0,136
6057780	400 17X19	17x19	210	0,179
6058670	400 19X22	19x22	230	0,246
6057860	400 22X24	22x24	250	0,335
6058750	400 24X27	24x27	270	0,408
6058830	400 30X32	30x32	300	0,575
1933175*	400 36X41	36x41	351	0,980
2297183*	400 46X50	46x50	396	0,800

i NO. 6

Strong and accurate

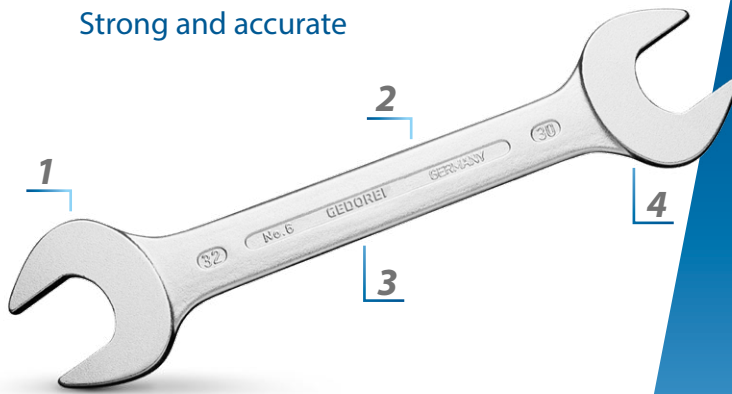

- Acc. to DIN 3110, ISO 3318, ISO 1085, ISO 10102
- Top-grade industrial quality for the hardest of continuous use
- Overloading indicated by deformation
- GEDORE vanadium steel 31CrV3, heads finely polished, chrome-plated

1 JAW: GROUND PRECISELY TO EXACT NOMINAL SIZE FOR OPTIMUM CONTACT AREAS

2 NON-GLARE LOOK THANKS TO MATT CHROME-PLATING

3 SECURE GRIP THANKS TO SLIM PROFILE SHAFT

4 SLIM PATTERN

6 (MM)

Double open ended spanner metric

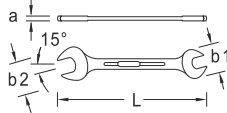

- > With different key widths
- > For hard to reach places thanks to very flat head

* not standardised

Code	No.	mm	L	kg	Code	No.	mm	L	kg
2312107*	6 55X60	55x60	560	3,160	6066500	6 18X19	18x19	222	0,174
6063400*	6 4X4,5	4x4.5	100	0,014	6066690*	6 17X22	17x22	236	0,205
6063590*	6 4X5	4x5	100	0,013	6066770	6 19X22	19x22	236	0,219
6063670*	6 5X5,5	5x5.5	100	0,016	6066850*	6 20X22	20x22	236	0,213
6063750*	6 5,5X7	5.5x7	122	0,023	6066930	6 19X24	19x24	250	0,256
6063830	6 6X7	6x7	122	0,022	6067070*	6 21X23	21x23	247	0,245
6063910*	6 6X8	6x8	122	0,025	6067150	6 22X24	22x24	250	0,260
6064050	6 7X8	7x8	140	0,034	6067230*	6 22X27	22x27	266	0,336
6064130*	6 7X9	7x9	140	0,035	6067310*	6 24X26	24x26	266	0,321
6064210	6 8X9	8x9	140	0,035	6067580	6 24X27	24x27	266	0,337
6064480	6 8X10	8x10	140	0,036	6067660	6 24X30	24x30	280	0,390
6064560*	6 9X10	9x10	157	0,046	6067740*	6 25X28	25x28	280	0,378
6064640*	6 9X11	9x11	157	0,050	6067820*	6 27X29	27x29	302	0,456
6064720	6 10X11	10x11	157	0,050	6067900	6 27X30	27x30	302	0,466
6064800*	6 10X12	10x12	157	0,051	6068040	6 27X32	27x32	302	0,487
6064990	6 10X13	10x13	172	0,065	6068120	6 30X32	30x32	302	0,504
6065100	6 11X13	11x13	172	0,068	6068200	6 30X36	30x36	328	0,677
6065290*	6 11X14	11x14	172	0,072	6068390	6 32X36	32x36	328	0,594
6065370	6 12X13	12x13	172	0,069	6068470	6 36X41	36x41	360	0,770
6065450	6 12X14	12x14	172	0,076	6068550*	6 38X42	38x42	360	0,784
6065530	6 13X14	13x14	178	0,081	6068630	6 41X46	41x46	400	1,104
6065610	6 13X15	13x15	188	0,098	6068710	6 46X50	46x50	450	1,445
6065880	6 14X15	14x15	188	0,095	6068980	6 13X16	13x16	190	0,098
6065960	6 13X17	13x17	205	0,122	6069360	6 18X21	18x21	236	0,196
6066180	6 14X17	14x17	205	0,119	6069440	6 21X24	21x24	250	0,268
6066260	6 16X17	16x17	205	0,128	6069520	6 30X34	30x34	302	0,503
6066340	6 16X18	16x18	205	0,129	6069600	6 34X36	34x36	328	0,624
6066420	6 17X19	17x19	222	0,168					

Spanners

6 (AF)

Double open ended
spanner
inch

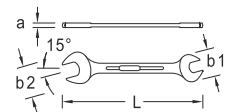

- > With different key widths
- > For hard to reach places thanks to very flat head

Code	No.	AF	L	
6070020	6 1/4X5/16AF	1/4"x5/16"	122	0,024
6070100	6 5/16X3/8AF	5/16"x3/8"	140	0,035
6070290	6 3/8X7/16AF	3/8"x7/16"	157	0,047
6070370	6 7/16X1/2AF	7/16"x1/2"	172	0,065
6070450	6 1/2X9/16AF	1/2"x9/16"	190	0,091
6070530	6 9/16X5/8AF	9/16"x5/8"	190	0,092
6070610	6 19/32X11/16AF	19/32"x11/16"	205	0,130
6070880	6 5/8X11/16AF	5/8"x11/16"	205	0,124
6070960	6 5/8X3/4AF	5/8"x3/4"	222	0,152
6071260	6 3/4X25/32AF	3/4"x25/32"	222	0,189
6071340	6 3/4X7/8AF	3/4"x7/8"	236	0,216
6071420	6 25/32X13/16AF	25/32"x13/16"	236	0,206
6071500	6 13/16X7/8AF	13/16"x7/8"	236	0,232
6071690	6 7/8X15/16AF	7/8"x15/16"	250	0,268
6071770	6 15/16X1AF	15/16"x1"	266	0,317
6071930	6 1X1.1/8AF	1"x1.1/8"	280	0,395
6072070	6 1.1/16X1.1/8AF	1.1/16"x1.1/8"	302	0,453
6072150	6 1.1/16X1.1/4AF	1.1/16"x1.1/4"	302	0,520
6072230	6 1.1/8X1.5/16AF	1.1/8"x1.5/16"	302	0,537
6072310	6 1.3/16X1.5/16AF	1.3/16"x1.5/16"	302	0,521
6072580	6 1.1/4X1.3/8AF	1.1/4"x1.3/8"	328	0,604
6072820	6 1.3/8X1.1/2AF	1.3/8"x1.1/2"	328	0,655
6073550	6 7/8X1.1/16AF	7/8"x1.1/16"	266	0,323

6 (MM)

Double open ended
spanner set

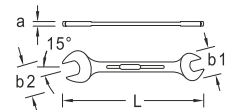

- > Practical composition
- > With different key widths
- > For hard to reach places thanks to very flat head

Code	No.	Contents	Pieces	
6077380	6-8	6x7 8x9 10x11 12x13 14x15 16x17 18x19 20x22 mm	8	0,819
6079400	H 6-8	6x7 8x9 10x11 12x13 14x15 16x17 18x19 20x22 mm	8	0,995
6077540	6-10	6x7 8x9 10x11 12x13 14x15 16x17 18x19 20x22 21x23 24x27 mm	10	1,412
6077620	6-100	6x7 8x9 10x11 12x13 14x15 16x17 18x19 20x22 24x27 30x32 mm	10	1,660
6077700	6-12	6x7 8x9 10x11 12x13 14x15 16x17 18x19 20x22 21x23 24x26 25x28 27x32 mm	12	2,500
6077890	6-120	6x7 8x9 10x11 12x13 14x15 16x17 18x19 20x22 21x23 24x27 25x28 30x32 mm	12	2,520
6078350	6-122 ISO	6x7 8x9 10x11 12x13 14x15 16x18 17x19 20x22 21x23 24x26 27x32 30x34 mm	12	2,383
6079750	H 6-120	6x7 8x9 10x11 12x13 14x15 16x17 18x19 20x22 21x23 24x27 25x28 30x32 mm	12	2,645

8 (MM)

Double open ended
spanner
small

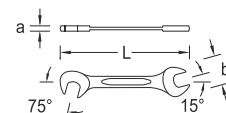

- > Small version
- > With same size each end
- > Jaw set at 15° and 75°

Code	No.	mm	L		Code	No.	mm	L	
6093900	8 4	4x4	69	0,005	6094550	8 8	8x8	95,5	0,016
6094040	8 4,5	4.5x4.5	69	0,006	6094630	8 9	9x9	103,8	0,020
6094120	8 5	5x5	77,3	0,006	6094710	8 10	10x10	103,8	0,021
6094200	8 5,5	5.5x5.5	77,3	0,007	6094980	8 11	11x11	115,2	0,028
6094390	8 6	6x6	77,3	0,008	6095010	8 12	12x12	115,2	0,028
6094470	8 7	7x7	89,5	0,011	6095280	8 13	13x13	130,5	0,037

8-011

Double open ended
spanner set
11 pieces



- > With same size each end
- > Jaw set at 15° and 75°
- > In plastic case

Code	No.	Contents	Pieces	
1879146	8-011	4,5 5 5,5 6 7 8 9 10 11 12 13 mm	11	0,28

8-0100

Double open ended
spanner set
10 pieces



- > With same size each end
- > Jaw set at 15° and 75°
- > In plastic bag

Code	No.	Contents	Pieces	
6099000	8-0100	5,5 5 6 7 8 9 10 11 12 13 mm	10	0,225

i NO. 895 UND NO. 894

The single in doubles and the single



- Carefully forged and professionally machined
- Jaw: ground precisely to exact nominal size for optimum contact areas
- Overloading indicated by deformation
- Secure grip thanks to profile shaft - very ergonomic and handy
- Jaw set at 15°
- GEDORE vanadium steel 31CrV3

895

Double open ended
spanner
metric

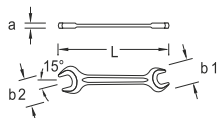

- > Manganese phosphate finish up to 34x36 mm, steel-grey up from 36x41 mm
- > Jaw set at 15°

*** not standardised**

Code	No.	mm	L	Code	No.	mm	L
6583910	895 7X8	7x8	107	6587580	895 24X30	24x30	269
6584130	895 8X9	8x9	108	6587740	895 27X32	27x32	275
6584640*	895 9X11	9x11	122	6587820	895 30X32	30x32	278
6585100	895 11X13	11x13	140	6587900	895 30X36	30x36	306
6585450	895 12X14	12x14	140	6588040	895 32X36	32x36	310
6585880*	895 14X15	14x15	154	6583080	895 34X36	34x36	320
6586420*	895 17X22	17x22	192	6588120	895 36X41	36x41	347
6587150*	895 22X27	22x27	233	6588200	895 41X46	41x46	383
6587230	895 24X27	24x27	246				

Spanners

894 (MM) / (AF)

Single open ended
spanner
metric

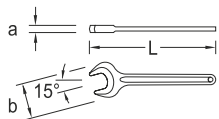

- > Jaw set at 15°
- * not standardised

Code	No.	mm	"AF	L	kg	Code	No.	mm	"AF	L	kg
6573600	894 6	6		73	0,010	6577780	894 75	75		610	2,782
6573790	894 7	7		78	0,010	6577860	894 80	80		645	2,905
6573870	894 8	8		94	0,015	6577940	894 85	85		690	3,895
6573950	894 9	9		100	0,017	6578080*	894 90	90		690	3,720
6574090	894 10	10		106	0,022	6578160*	894 95	95		847	6,335
6574170	894 11	11		112	0,029	6578240*	894 100	100		847	6,125
6574250	894 12	12		124	0,035	6578320*	894 105	105		1.000	8,905
6574330	894 13	13		132	0,039	6578400*	894 110	110		1.000	8,650
6574410	894 14	14		140	0,044	6578590*	894 115	115		1.000	8,480
6574680	894 15	15		145	0,046	6578670*	894 120	120		1.000	8,260
6574760	894 16	16		155	0,056	6576030*	894 125	125		1.000	8,345
6574840	894 17	17		159	0,060	6576110*	894 130	130		1.000	8,230
6575220	894 18	18		165	0,067	6576460*	894 135	135		1.000	7,775
6575060	894 19	19		170	0,081	6579720	894 3/8AF		3/8"	100	0,014
6575300	894 22	22		193	0,113	6579990	894 7/16AF		7/16"	112	0,026
6575570	894 24	24		217	0,154	6580300	894 5/8AF		5/8"	155	0,053
6575650*	894 25	25		217	0,142	6580570	894 3/4AF		3/4"	170	0,074
6575810	894 27	27		239	0,199	6580730	894 13/16AF		13/16"	170	0,074
6576380	894 30	30		263	0,249	6580810	894 7/8AF		7/8"	193	0,106
6576540	894 32	32		275	0,374	6581030	894 15/16AF		15/16"	217	0,147
6575730	894 34	34		290	0,365	6581380	894 1.1/16AF		1.1/16"	239	0,186
6576700	894 36	36		305	0,392	6581460	894 1.1/8AF		1.1/8"	239	0,205
6576890*	894 38	38		305	0,406						
6576970	894 41	41		344	0,568						
6577000	894 46	46		380	0,704						
6577190	894 50	50		413	0,956						
6577270	894 55	55		459	1,125						
6577350	894 60	60		494	1,439						
6577430	894 65	65		528	1,686						
6577510	894 70	70		572	2,111						

60 CP

Single open ended
spanner
adjustable, chromed

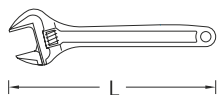

- > Swedish pattern, roller with left hand thread
- > Jaw set at 15°
- > With adjusting scale

Code	No.	Size "	L	mm	"inch	kg
6380990	60 CP 6	6	155	20	25/32	0,145
6381020	60 CP 8	8	205	25	1	0,270
6381100	60 CP 10	10	255	30	1.3/16	0,420
6381290	60 CP 12	12	305	36	1.7/16	0,785

60 P

Single open ended
spanner
adjustable, phosphated

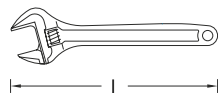

- > Swedish pattern, roller with left hand thread
- > Jaw set at 15°
- > With adjusting scale

Code	No.	Size "	L	mm	"inch	kg
6380560	60 P 6	6	155	20	25/32	0,145
6380640	60 P 8	8	205	25	1	0,295
6380720	60 P 10	10	255	30	1.3/16	0,430
6380800	60 P 12	12	305	36	1.7/16	0,705

62 P

Single open ended
spanner
adjustable, phosphated

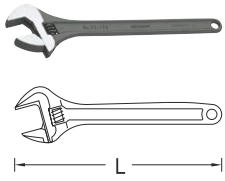

- > Swedish pattern, roller with left hand thread
- > Sturdy industrial design
- > Sizes 15" - 18" = ISO 6787, jaw position 15°
- > Size 24" = ISO 6787, jaw position 22.5°

Code	No.	Size "	L	mm	"inch	
6368430	62 P 15	15	380	43	1.11/16	1,060
6368510	62 P 18	18	455	53	2.1/16	1,715
6360880	62 P 24	24	610	63	2.1/2	3,555

60 S

Single open ended
spanner
adjustable

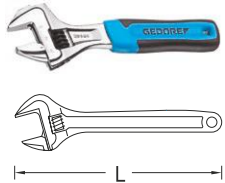

- > Swedish pattern, roller with left hand thread
- > Jaw set at 15°
- > With adjusting scale

Code	No.	Size "	L	mm	
2668815	60 S 6 P	6	153	20	0,160
1966294	60 S 8 P	8	206,5	25	0,340
2171023	60 S 10 P	10	254,5	30	0,251
2668823	60 S 6 JP	6	153	20	0,180
1966308	60 S 8 JP	8	206,5	25	0,360
2171015	60 S 10 JP	10	254,5	30	0,500
2668831	60 S 6 C	6	153	20	0,180
2668882	60 S 12 JP	12	305	36	0,860
2668890	60 S 12 C	12	305	36	0,780
1966316	60 S 8 C	8	206,5	25	0,340
2171007	60 S 10 JC	10	254,5	30	0,500
2170973	60 S 10 C	10	254,5	30	0,480
2668858	60 S 6 JC	6	153	20	0,180
1966324	60 S 8 JC	8	206,5	25	0,360
2668904	60 S 12 JC	12	305	36	0,860

NO. 2 A

The strong



- Heavy-duty pattern for highest torques
- GEDORE vanadium steel 31CrV3, chrome plated
- **Special sizes available on request**
- Optional accessories: No. 2 AR extension tube for extending the lever arm



No. 2A + 2AR

2 A

Single ended
ring spanner
offset

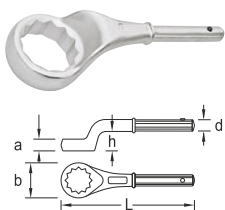

- > Heavy-duty pattern for highest torques
- > Special sizes available on request
- > Optional accessories: No. 2 AR extension tube for extending the lever arm

Code	No.	mm	L		Code	No.	mm	L	
6033840	2 A 24	24	180	0,389	6034650	2 A 55	55	300	1,492
6033920	2 A 27	27	190	0,430	6034730	2 A 60	60	345	2,283
6034060	2 A 30	30	200	0,514	6034810	2 A 65	65	355	2,535
6034140	2 A 32	32	235	0,732	6035030	2 A 70	70	365	2,736
6030150	2 A 34	34	235	0,748	6035110	2 A 75	75	375	2,982
6034220	2 A 36	36	245	0,796	6035380	2 A 80	80	385	3,770
6034300	2 A 41	41	265	0,934	6035460	2 A 85	85	385	3,605
6034490	2 A 46	46	280	1,220	6035540	2 A 90	90	410	4,850
6034570	2 A 50	50	290	1,388	6035620	2 A 95	95	410	4,540

Spanners

2 AR Extension-tube



- > For single ended ring spanner no. 2 A
- > Ideal for extending the lever arm and applying higher forces

Code	No.	Internal-Ø	Ø mm	↳ mm	⚖️
6048600	2 AR 0	19 mm	24-30	460	0,614
6048790	2 AR 1	22 mm	32-41	610	1,568
6048870	2 AR 2	25 mm	46-55	760	2,840
6048950	2 AR 3	30 mm	60-95	860	3,715

2 ATM Single ended ring spanner set 19 pieces



- > Heavy-duty pattern for highest torques
- > With push-on tubes No. 2 AR to extend the lever arm
- > With UD profile for easy power transmission; from SW 65 12-edge
- > Incl. wall board made of sheet steel and hook set

Code	No.	Contents	Pieces	⚖️
6049250	2 ATM	2 A 24 27 30 32 36 41 46 50 55 60 65 70 75 80 85 2 AR 0 1 2 3 Sheet steel board with hook set	19	53

i THE POWERFUL



- Top-grade industrial quality for the hardest of continuous use
- For very heavy-duty work
- Special sizes available on request up to size 250 mm

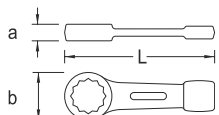

306 (MM) / 306 (AF) Ring slogging spanner



- > For heavy-duty work
- > Special sizes available on request

*** not standardised**

Code	No.	Ø mm	Ø "AF	L	⚖️
1344331*	306 22	22		165	0,230
6475000*	306 24	24		160	0,262
6475190	306 27	27		180	0,328
6475270	306 30	30		190	0,393
6475350	306 32	32		195	0,428
6481670	306 34	34		195	0,401
6475430	306 36	36		205	0,674
6474460*	306 38	38		205	0,635
6475510	306 41	41		225	0,790
6475780	306 46	46		240	0,999
6475860	306 50	50		250	1,093
6475940	306 55	55		270	1,452
6476080	306 60	60		270	1,577
6476160	306 65	65		290	2,580
6476240	306 70	70		320	2,660

Code	No.	 mm	 AF	L	
6476320	306 75	75		325	3,010
6476400	306 80	80		345	3,515
6476590	306 85	85		360	3,895
6476670	306 90	90		400	6,370
6476750	306 95	95		400	6,285
6476830	306 100	100		400	5,820
6476910	306 105	105		435	8,660
6477050	306 110	110		435	8,440
6477130	306 115	115		435	8,160
6477210	306 120	120		480	9,855
6477480*	306 125	125		480	9,665
6477560	306 130	130		520	12,295
6477640	306 135	135		520	11,790
6474540	306 1AF		1"	160	0,262
6474620	306 1.1/16AF		1.1/16"	180	0,325
6474700	306 1.1/8AF		1.1/8"	180	0,315
6474890	306 1.3/16AF		1.3/16"	190	0,389
6478530	306 1.5/16AF		1.5/16"	195	0,415
6478610	306 1.3/8AF		1.3/8"	195	0,409
6478880	306 1.7/16AF		1.7/16"	205	0,660
6478960	306 1.1/2AF		1.1/2"	205	0,641
6479180	306 1.5/8AF		1.5/8"	225	0,820
6479260	306 1.11/16AF		1.11/16"	225	0,766
6479340	306 1.3/4AF		1.3/4"	225	0,770
6479420	306 1.13/16AF		1.13/16"	240	0,982
6479500	306 1.7/8AF		1.7/8"	240	0,985
6479770	306 2.1/16AF		2.1/16"	250	1,079
6479850	306 2.1/8AF		2.1/8"	250	1,039
6479930	306 2.3/16AF		2.3/16"	270	1,431
6480000	306 2.1/4AF		2.1/4"	270	1,397
6480190	306 2.3/8AF		2.3/8"	270	1,616
6480350	306 2.9/16AF		2.9/16"	290	2,076
6480430	306 2.5/8AF		2.5/8"	290	2,035
6480510	306 2.3/4AF		2.3/4"	320	2,545
6480780	306 3AF		3"	325	3,005

WWW.GEDORE.COM

Spanners

306 G Ring slogging spanner cranked

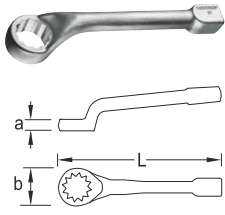

- > For heavy-duty work
- > For use with club hammer or pneumatic hammer for tightening or loosening

Code	No.	mm	L	kg
1415875	306 G 27	27	270	1,098
1415913	306 G 30	30	270	1,080
1415972	306 G 32	32	270	1,061
1416014	306 G 36	36	310	2,010
1416057	306 G 41	41	310	1,842
1416111	306 G 46	46	340	2,950
1416197	306 G 50	50	360	4,410
1416227	306 G 55	55	360	4,155

Code	No.	mm	L	kg
1416308	306 G 60	60	380	5,690
1416332	306 G 65	65	380	5,490
1416405	306 G 70	70	406	7,455
1416456	306 G 75	75	406	7,165
1416480	306 G 80	80	406	6,970
1416537	306 G 85	85	459	10,630
1416553	306 G 90	90	459	10,480
1416588	306 G 95	95	459	9,830

133 Open ended slogging spanner

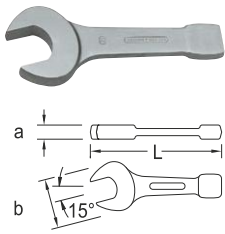

- > For heavy-duty work
- > Special sizes available on request

*** not standardised**

Code	No.	mm	L	kg
6410570	133 27	27	181	0,385
6400260	133 30	30	188	0,451
6400340	133 32	32	196	0,552
6411030	133 34	34	196	0,559
6400420	133 36	36	211	0,709
6400500	133 41	41	227	1,000
6400690	133 46	46	256	1,258
6400770	133 50	50	281	1,609
6400850	133 55	55	310	2,131
6400930	133 60	60	321	2,484
6401070	133 65	65	351	3,340
6401150	133 70	70	370	4,325

Code	No.	mm	L	kg
6401230	133 75	75	390	5,110
6401310	133 80	80	406	6,020
6401580	133 85	85	406	5,770
6401660	133 90	90	456	8,905
6401740	133 95	95	456	8,985
6401820	133 100	100	500	13,315
6401900	133 105	105	500	13,220
6402040	133 110	110	500	13,045
6402120	133 115	115	525	17,660
6402200	133 120	120	525	17,610
6402390*	133 125	125	545	16,760
6402470	133 130	130	575	19,030

308 Deep ring spanner straight

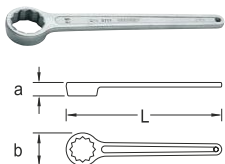

- > Especially suitable for locking screw connections
- > Special sizes available on request

*** not standardised**

Code	No.	mm	L	kg
6481830*	308 36	36	295	0,473
6481910	308 41	41	330	0,717
6482050	308 46	46	365	0,925
6482130	308 50	50	400	1,230

Code	No.	mm	L	kg
6482210	308 55	55	442	1,626
6482480	308 60	60	475	1,792
6482560*	308 65	65	510	2,208

i THE SPECIAL

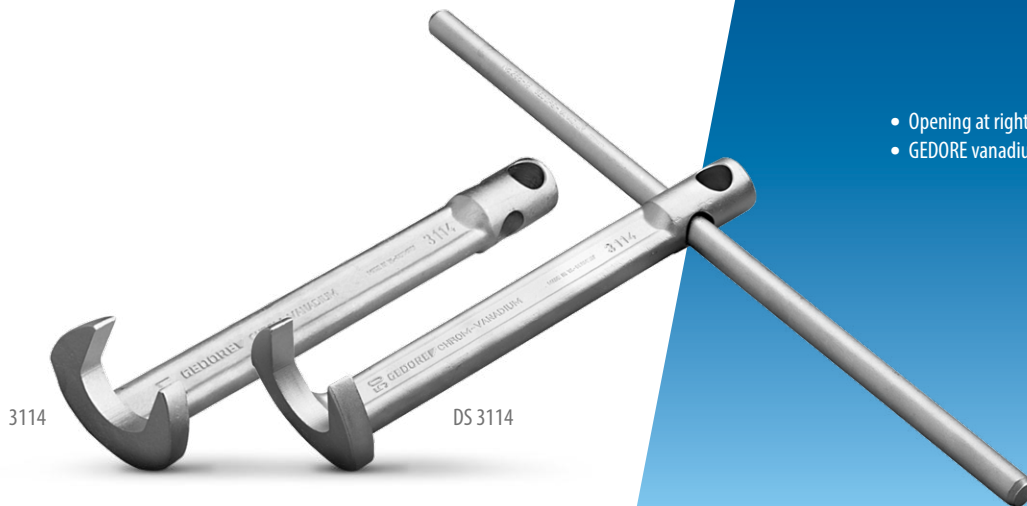

- Opening at right angle to shaft for maximum accessibility
- GEDORE vanadium steel 31CrV3, chrome-plated

3114 Crowfoot spanner

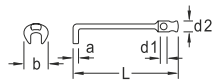

- > Angled open-end wrench for working in hard-to-reach areas
- > Delivery without pivot pin

Code	No.	Ø mm	L	26 D	kg
6670050	3114 13	13	160	8	0,095
6670130	3114 14	14	160	8	0,093
6676920	3114 16	16	200	10	0,160
6670210	3114 17	17	200	10	0,169
6677060	3114 18	18	200	12	0,216
6670480	3114 19	19	200	12	0,224
6677140	3114 21	21	200	12	0,272
6670560	3114 22	22	200	12	0,265
6670640	3114 24	24	250	14	0,419
6670720	3114 27	27	250	14	0,519
6670800	3114 30	30	250	16	0,633
6670990	3114 32	32	250	16	0,712
6671020	3114 36	36	315	18	1,034

26 D Tommy bar



- > Acc. to DIN 900 Form A
- > Chrome-vanadium steel 31CrV3, chrome-plated

Code	No.	Ø	L	kg	Code	No.	Ø	L	kg
6208580	26 D 6	6,00	157	0,040	6209040	26 D 14	14,00	316	0,386
6208740	26 D 8	8,00	177	0,073	6209120	26 D 16	16,00	396	0,634
6208820	26 D 10	10,00	197	0,127	6209200	26 D 18	18,00	495	0,995
6208900	26 D 12	12,00	246	0,228	6209390	26 D 20	20,00	625	1,555

534 Combination swivel head wrench

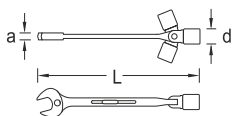

- > Slim pattern, with free moving socket wrench
- > With hole for tommy bars 26 D and 26 RS (please order separately)

Code	No.	Ø mm	L	26 D	26 RS	kg
6512060	534 10	10	179		1	0,071
6512140	534 11	11	189		1	0,087
6512220	534 12	12	198		1	0,115
6512300	534 13	13	208		1	0,140
6512490	534 14	14	218	6	1	0,151
6512570	534 15	15	231	6	1	0,169
6512650	534 16	16	244	6	1	0,222
6512730	534 17	17	255	8	2	0,237
6513030	534 18	18	269	8	2	0,273
6512810	534 19	19	283	8	2	0,304

Spanners

34 Swivel head wrench double ended

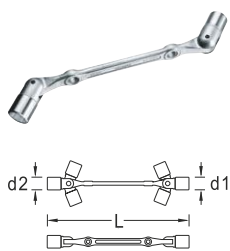

- > With different key widths
- > Thin walled heads, UD profile
- > Swivels through a wide radius
- > Shaft with holes for tommy bars 26 D and 26 RS (please order separately)

Code	No.	⊙ mm	L	26 D	26 RS	⚖️
6299010	34 8X9	8 x 9	200	6	1	0,098
6299280	34 10X11	10 x 11	205	6	1	0,110
6299360	34 12X13	12 x 13	240	8	2	0,204
6299600	34 13X17	13 x 17	275	10	2	0,318
6299520	34 14X15	14 x 15	245	8	2	0,216
6299870	34 16X17	16 x 17	280	10	2	0,334
6299950	34 17X19	17 x 19	315	12	3	0,411
6300040	34 18X19	18 x 19	315	12	3	0,418
6300120	34 20X22	20 x 22	350	12	3	0,604
6300200	34 21X23	21 x 23	350	12	3	0,633
6300390	34 24X27	24 x 27	410	14	3	0,913

IN 34 Swivel head wrench double ended for in-hex screws

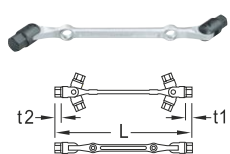

- > Swivels through a wide radius
- > Shaft with holes for tommy bars 26 D and 26 RS (please order separately)

Code	No.	⊙ mm	L	26 D	26 RS	⚖️
6302330	IN 34 5X6	5 x 6	202	6	1	0,107
6302680	IN 34 12X14	12 x 14	270	10	2	0,336
6302760	IN 34 17X19	17 x 19	295	12	3	0,411

25 Socket wrench offset

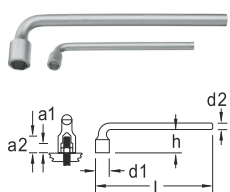

- > Solid design with particularly large head depth for protruding bolts, hexagonal
- > With dome for pointed screw heads

Code	No.	⊙	L	⚖️
6188290	25 10	10	160	0,120
6188530	25 13	13	200	0,220
6188880	25 17	17	250	0,373
6188960	25 19	19	280	0,539
6189340	25 27	27	380	1,179

25 V Socket wrench offset

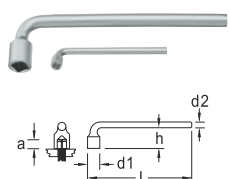

- > Solid design with particularly large head depth, square
- > Ideal for protruding bolts

Code	No.	⊙	L	⚖️
6194770	25 V 8	8	150	0,116
6194850	25 V 9	9	160	0,126
6194930	25 V 10	10	175	0,203
6195150	25 V 12	12	215	0,335
6195230	25 V 13	13	230	0,357
6195310	25 V 14	14	240	0,378
6195580	25 V 17	17	280	0,718

25 PK Tubular box spanner offset with hole

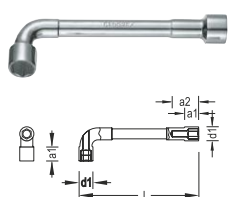

- > Solid pattern with two hexagon heads
- > Deep bores above the hexagon heads to take long studs
- > The rotary pin can also be used on the angled side (e.g. No. 26 D, please order separately)

Code	No.	⊙	L	⚖️	Code	No.	⊙	L	⚖️
1616323	25 PK 6	6	105	0,080	1436899	25 PK 17	17	187	0,305
1616331	25 PK 7	7	107	0,081	1436902	25 PK 18	18	195	0,385
1616358	25 PK 8	8	112	0,091	1436910	25 PK 19	19	205	0,440
1436805	25 PK 9	9	120	0,099	1436929	25 PK 21	21	225	0,620
1436813	25 PK 10	10	130	0,116	1436937	25 PK 22	22	225	0,632
1436821	25 PK 11	11	136	0,122	1436945	25 PK 24	24	248	0,814
1436848	25 PK 12	12	145	0,166	1436953	25 PK 27	27	280	1,088
1436856	25 PK 13	13	152	0,192	1436961	25 PK 30	30	310	1,500
1436864	25 PK 14	14	160	0,216	1436988	25 PK 32	32	330	1,475
1616366	25 PK 15	15	170	0,239	1436996	25 PK 34	34	340	1,580
1436872	25 PK 16	16	178	0,275	1437003	25 PK 36	36	355	2,052

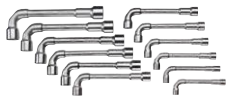
25 PK-012Tubular box spanner set
12 pieces

- > Solid pattern with two hexagon heads
- > Deep bores above the hexagon heads to take long studs
- > The rotary pin can also be used on the angled side (e.g. No. 26 D, please order separately)

Code	No.	Contents	Pieces	
1527312	25 PK-012	8 9 10 11 12 13 14 15 16 17 18 19 mm	12	2,578

626

Tubular box spanner

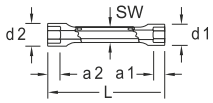

- > With hexagonal shaft
- > With through-holes for operation with open-ended spanner or rotary pin (No. 626 S / No. 26 RS-626 S)
- > Sizes 6x7 and 8x9 mm with no hole

Code	No.	mm	L	SW mm	26 RS-626 S	
6525120	626 6X7	6 x 7	105	8,0	626 S 1	0,037
6525200	626 8X9	8 x 9	110	9,0	626 S 1	0,052
6525390	626 10X11	10 x 11	120	11,0	626 S 1	0,072
6525470	626 12X13	12 x 13	140	13,0	626 S 1	0,117
6520750	626 13X17	13 x 17	155	15,0	626 S 2	0,160
6525710	626 14X15	14 x 15	145	14,0	626 S 1	0,145
6526280	626 16X17	16 x 17	155	16,0	626 S 2	0,189
6526360	626 17X19	17 x 19	165	18,0	626 S 2	0,233
6526440	626 18X19	18 x 19	165	18,0	626 S 2	0,242
6526520	626 19X22	19 x 22	175	19,0	626 S 2	0,288
6526600	626 20X22	20 x 22	175	19,0	626 S 2	0,306
6526870	626 24X26	24 x 26	195	24,0	26 RS-626 S 3	0,452
6526950	626 24X27	24 x 27	195	24,0	26 RS-626 S 3	0,493
6527170	626 30X32	30 x 32	210	30,0	26 RS-626 S 3	0,725
6527250	626 32X36	32 x 36	225	32,0	26 RS-626 S 3	0,898

626 S

Stepped tommy bar



Code	No.	Ø1	Ø2	Ø3	Ø4	Ø5	« mm »	
6528060	626 S 1	3,70	4,70	5,20	7,00		190	0,050
6528140	626 S 2	6,70	7,70	8,70	9,70	11,00	240	0,159
6528220	26 RS-626 S-3	11,70	13,70	16,00			310	0,492

KD 626Tubular box spanner set
with tommy bar

- > Practical assembly of double socket wrenches with rotary pins
- > Similar to DIN 896, Form A, ISO 2236, ISO 1085
- > With hexagon shaft and holes for turning, either with a spanner or a tommy bar (626 S / 26 RS-626 S, see table, please order separately)
- > Sizes 6x7 and 8x9 mm with no hole

Code	No.	Contents	Pieces	
6528730	KD 626-8	626 6x7 8x9 10x11 12x13 14x15 16x17 18x19 20x22 mm 626 S 1 2	8	1,434

26 R

Tubular box spanner

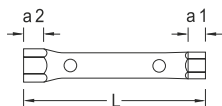

- > With different key widths
- > With hollow shaft, in tubular steel, DIN 2391 seamless, hardened, made from material C35, chrome-plated
- > With hole for tommy bars 26 D and 26 RS (please order separately)

* not standardised

Code	No.	Ø	L	26 D	26 RS	
6222810*	26 R 5,5X7	5,5 x 7	105	6	1	0,036
6210050	26 R 6X7	6 x 7	105	6	1	0,035
6210210	26 R 8X9	8 x 9	105	6	1	0,041
6210480	26 R 8X10	8 x 10	120	6	1	0,049
6210640	26 R 10X11	10 x 11	120	6	1	0,055
6210720	26 R 10X13	10 x 13	140	8	2	0,072
6210800	26 R 11X13	11 x 13	140	8	2	0,074
6210990	26 R 12X13	12 x 13	140	8	2	0,073
6211020	26 R 12X14	12 x 14	140	8	2	0,083
6211100*	26 R 13X14	13 x 14	140	8	2	0,083
6211290*	26 R 13X15	13 x 15	140	8	2	0,089
6211370	26 R 14X15	14 x 15	140	8	2	0,088
6211450	26 R 13X17	13 x 17	150	10	2	0,139
6211530	26 R 14X17	14 x 17	150	10	2	0,140
6211610	26 R 16X17	16 x 17	150	10	2	0,139
6223030	26 R 16X18	16 x 18	150	10	2	0,152
6211880	26 R 17X19	17 x 19	155	12	3	0,161
6211960	26 R 18X19	18 x 19	155	12	3	0,161
6212180	26 R 19X22	19 x 22	165	12	3	0,261
6212260	26 R 20X22	20 x 22	165	12	3	0,264
6212340	26 R 21X23	21 x 23	165	14	3	0,291
6212420	26 R 22X24	22 x 24	180	14	3	0,291
6212500	26 R 24X26	24 x 26	180	14	3	0,314
6212690	26 R 24X27	24 x 27	180	14	3	0,319
6212770	26 R 25X28	25 x 28	195	16	3	0,365
6212850	26 R 27X30	27 x 30	195	16	3	0,386
6212930	26 R 27X32	27 x 32	195	16	3	0,415
6213070	26 R 30X32	30 x 32	195	16	3	0,409
6213150	26 R 30X36	30 x 36	215	18	-	0,528
6213230	26 R 32X36	32 x 36	215	18	-	0,535
6213310	26 R 36X41	36 x 41	215	18	-	0,678
6213580	26 R 41X46	41 x 46	235	20	-	0,823
6213660	26 R 46X50	46 x 50	235	20	-	0,869
6213740	26 R 50X55	50 x 55	235	20	-	1,126

26 RS

Stepped tommy bar



Code	No.	Ø1	Ø2	Ø3	↳ mm ↲	
6219350	26 RS 1	5,00	6,00		190	0,045
6219430	26 RS 2	8,00	10,00		240	0,149
6528220	26 RS-626 S-3	11,70	13,70	16,00	310	0,492

KD 26 R

Tubular box spanner set with tommy bar



- > Practical assembly of double socket wrenches with rotary pins
- > Acc. to DIN 896, Form B, ISO 2236, ISO 1085
- > With hollow shaft, in tubular steel, DIN 2391 seamless, hardened, made from material C35, chrome-plated

Code	No.	Contents	Pieces	
6218540	KD 26 R-8	26 R 6x7 8x9 10x11 12x13 14x15 16x17 18x19 20x22 mm 26 RS 1 2 3	8	1,564
6218890	KD 26 R-120	26 R 6x7 8x9 10x11 12x13 14x15 16x17 18x19 20x22 21x23 24x27 25x28 30x32 mm 26 RS 1 2 3	12	2,895

45 S

Multi fitting key Universal



- > Key for opening and closing of master cabinets, switch panels, technical shut-off systems e.g. air-conditioning, inspection flaps
- > For the outdoor areas - locking of bins or waste containers, and street lamp lids etc.
- > Reversible bit: slot 1.0 x 7 mm and cross recess PH 2 as well as adapter for 1/4" bits on a fastening chain

- > 5 mm square for heating venting
- > Female square 5, 6, 7-8 mm
- > Female three-square 9 mm
- > Multi fitting key 3-5 mm

Code	No.	Dimensions
2190125	45 S	72 x 72

40

Hook wrench with lug

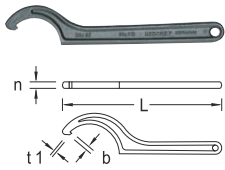

- > Design according to DIN 1810 form A
- > For slotted round nuts according to DIN 981

Code	No.	mm	L	kg
6333990	40 16-20	16-20	110	0,026
6334020	40 25-28	25-28	135	0,038
6334100	40 30-32	30-32	135	0,043
6334290	40 34-36	34-36	170	0,071
6334370	40 40-42	40-42	170	0,078
6334450	40 45-50	45-50	205	0,133
6334530	40 52-55	52-55	205	0,130
6334610	40 58-62	58-62	240	0,196
6334880	40 68-75	68-75	240	0,208

Code	No.	mm	L	kg
6334960	40 80-90	80-90	280	0,282
6335180	40 95-100	95-100	280	0,275
6335260	40 110-115	110-115	335	0,491
6335340	40 120-130	120-130	335	0,493
6335420	40 135-145	135-145	385	0,841
6335500	40 155-165	155-165	385	0,820
6335690	40 180-195	180-195	465	1,445
6335770	40 205-220	205-220	465	1,448

40 Z

Hook wrench with pin

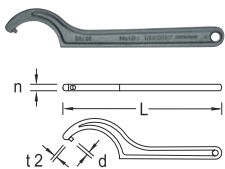

- > Design according to DIN 1810 form B
- > For cross-drilled nuts according to DIN 1816

Code	No.	mm	L	kg
6335850	40 Z 16-18	16-18	110	0,014
6335930	40 Z 20-22	20-22	110	0,014
6336580	40 Z 25-28	25-28	135	0,039
6336660	40 Z 30-32	30-32	135	0,045
6336740	40 Z 34-36	34-36	170	0,080
6336820	40 Z 40-42	40-42	170	0,079
6336900	40 Z 45-50	45-50	205	0,136
6337040	40 Z 52-55	52-55	205	0,129
6337120	40 Z 58-62	58-62	240	0,198

Code	No.	mm	L	kg
6337200	40 Z 68-75	68-75	240	0,198
6337390	40 Z 80-90	80-90	280	0,281
6337470	40 Z 95-100	95-100	280	0,276
6337550	40 Z 110-115	110-115	335	0,494
6337630	40 Z 120-130	120-130	335	0,492
6337710	40 Z 135-145	135-145	385	0,829
6337980	40 Z 155-165	155-165	385	0,841
6338010	40 Z 180-195	180-195	465	1,420
6338280	40 Z 205-220	205-220	465	1,402

44

Caliper face spanner adjustable

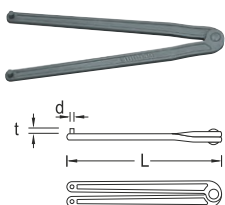

- > For loosening and clamping of cutting and grinding wheels
- > Similar to DIN 3116
- > Special sizes available on request

Code	No.	mm	L	L"	kg
6354480	44 3	3	178	7"	0,148
6354560	44 4	4	178	7"	0,151
6354640	44 5	5	230	9"	0,259

Code	No.	mm	L	L"	kg
6354720	44 6	6	230	9"	0,260
6354990	44 8	8	230	9"	0,265